



**Automating
Your Success®**

AMR-OP75

wall-mounted control unit

A new generation of universal wall controllers.



temperature
relative humidity
CO₂ concentration



PLAY VIDEO ▶

One device for several functions, the main task of the **AMR-OP75RHR**

The **wall-mounted control unit** differs from the others in many ways. At first glance, it is its design - the all-glass front with a high-quality, high-resolution colour touchscreen is unmistakable.

The **AMR-OP75RHR** can be mounted on a smooth wall or on a KU 68 mounting box. Communication with the supervisory system is provided by an **RS485 interface with MODBUS RTU support**. The backlight of the display can be user adjustable, or **the ambient backlight regulation function** can be used with respect to the ambient light conditions.

Usecase #1

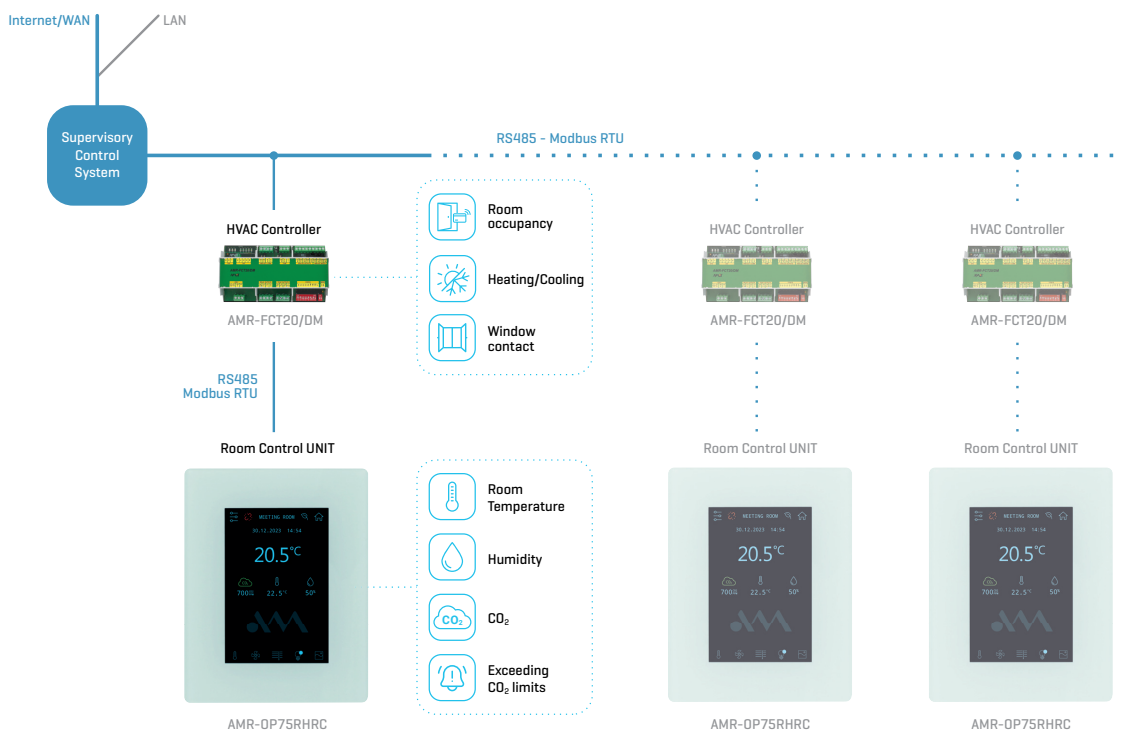

Usecase #2

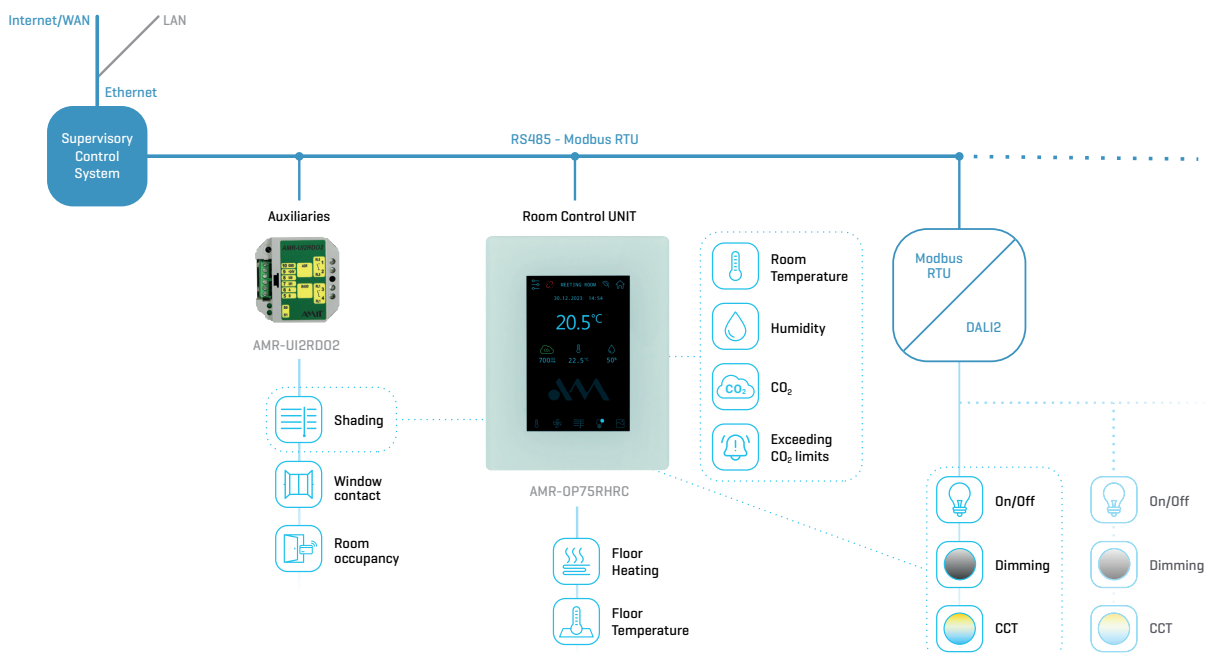

User Intuitive operation without complicated manuals and instructions

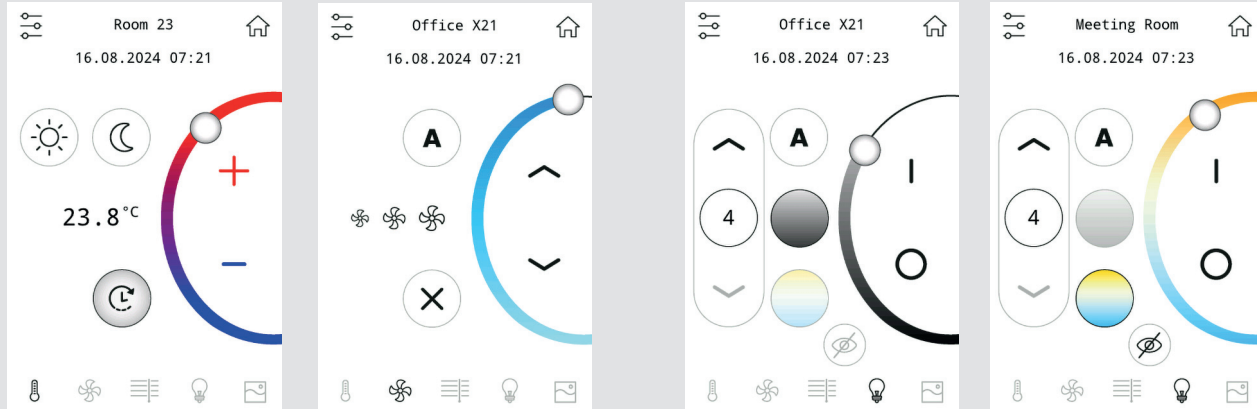

The unit includes **a software** that is easily configurable and covers most of the requirements for controlling technology in offices, hotels, hospitals or residential units.

Lighting control supports control of multiple circuits. The first circuit can be activated with a gesture [multi-touch] on any screen. Each circuit can be individually controlled depending on whether only **on/off** mode or **dimming** or **chromaticity control** is required.

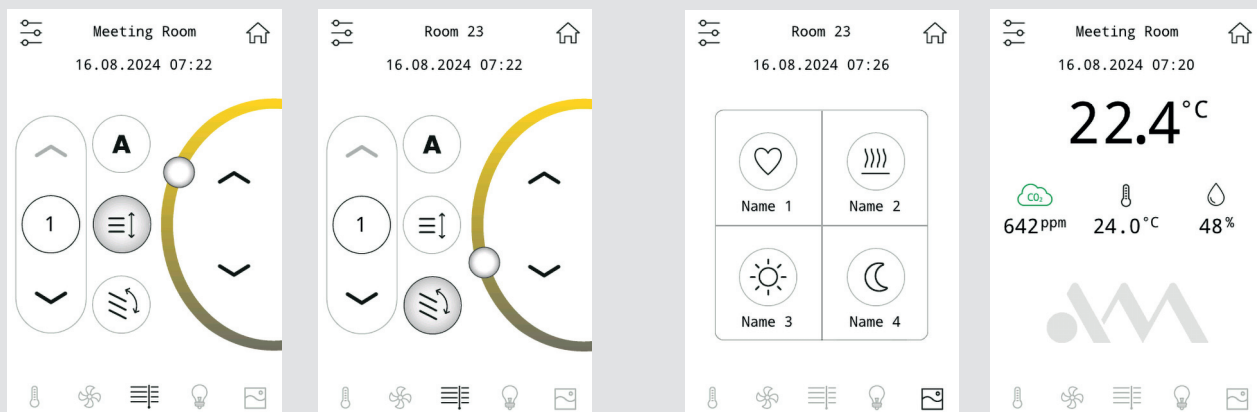

Shading control – depending on the different types of shading technology, a simple “two-button” or continuous control can be used, including the **tilting of the slats** for blind variants.

The individual light and shade circuits can be individually named for better clarity in use. On the home screen, the current **temperature**, **room humidity** and, in the version with **CO₂** measurement, the current concentration can be quickly checked.

Setting options by the service technician

For the service technician, the possibilities for specific unit settings are much greater. **In the system menu**, he can determine what control functions the unit will support, what type of lighting and shading circuits, modes of home screen display, unit communication parameters, access password settings, etc. To make configuration easier, you could use the **AppConfig** configuration program, which makes setup an easy task and, most importantly, can be reused to configure units already installed on an RS485 network.

It is obvious from the above description that we are bringing to the market a new type of unit for control systems that will cover a wide range of requirements for fully automated rooms. We believe that the **AMR-OP75RHR(C) combined control unit**, in cooperation with AMiT Automation control systems, will contribute to **improving the quality of the indoor environment in buildings** where, unfortunately, we spend more and more time.

The **AMR-OP75RHR** unit is available in white or black. The unit basically measures room **temperature, relative humidity**, has an input for an **external RTD/NTC temperature sensor** and a **switching relay** can be used as an output.

In the **AMR-OP75RHRC** version, the unit can also measure **the CO₂ concentration** in the room and signal its exceeding not only graphically but also audibly.



The unit can thus replace many different controllers, switches and on/off buttons that are common in rooms today:

- HVAC controller
- switches for light circuits and various on/off buttons for controlling blinds
- **measurement** and current concentration of **CO₂**
- audible signalling
- dark/light mode
- service technician mode

The combined control unit **AMR-OP75RHR(C)**, installed in the room, **combines (integrates) all these control peripherals into a single device.**

For all variants, there is an option to change the default logo on the home screen.

TECHNICAL INFORMATION

	AMR-OP75RHR/xx temperature, humidity, RTD/NTC, relay	AMR-OP75RHRC/xx temperature, humidity, CO ₂ concentration, RTD/NTC, relay
Control	Touch panel	Touch panel
Display	Graphic colour TFT	Graphic colour TFT
Resolution	[320 × 480] pixels	[320 × 480] pixels
Display area	[48.9 × 73.4] mm	[48.9 × 73.4] mm
Temperature and humidity measurement	Digital sensor	Digital sensor
Temperature/humidity measurement range	-10 °C to 50 °C / 20 % to 80 %	-10 °C to 50 °C / 20 % to 80 %
CO₂ concentration measurement	-	NDIR
Audible signalling	-	Piezo changer
RTD / NTC input	1 × RTD [Ni1000 / Pt1000] / NTC	1 × RTD [Ni1000 / Pt1000] / NTC
Relay output	1 × Switching contact	1 × Switching contact
Maximum switching current	0.25 A at 230 V AC / 24 V DC [resistive load]	0.25 A at 230 V AC / 24 V DC [resistive load]
Communication	RS485 [without G0], 256 units per segment	RS485 [without G0], 256 units per segment
Ingress protection rate	IP20	IP20
Mounting	Wall mounted / KU 68	Wall mounted / KU 68
Power supply	20 V DC up to 30 V DC	20 V DC up to 30 V DC
Dimensions [W × H × D]	[86 × 110 × 25] mm	[86 × 110 × 25] mm
Color option	White AMR-OP75RHR/01 Black AMR-OP75RHR/02	White AMR-OP75RHRC/01 Black AMR-OP75RHRC/02